

RESIDENCE 02C

INTERIOR EXTERIOR
 8,404 F² 1,290 F²
 780 M² 119 M²

TOTAL
 9,694 F²
 899 M²

*

- 6 BEDROOMS
- 7 BATHROOMS
- 1 POWDER ROOM
- FAMILY ROOM
- EXERCISE ROOM
- OFFICE
- WINE ROOM
- SERVICE SUITE

OCEAN VIEW

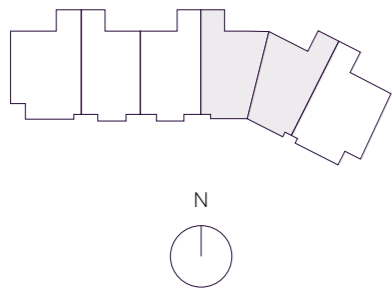

THE RESIDENCES

SIX FISHER ISLAND

⑥



PRIMARY BEDROOM
 23'-1" x 20'-1"

BALCONY
 15'-9" x 88'-10"

HER BATHROOM
 17'-7" x 14'-11"

FAMILY ROOM
 25'-11" x 20'-1"

GREAT ROOM
 29'-5" x 64'-5"

HIS BATHROOM
 12'-3" x 14'-9"

HER WARDROBE
 14'-10" x 18'-6"

HIS WARDROBE
 17'-5" x 14'-4"

KITCHEN
 16'-2" x 22'

WINE ROOM
 5'-3" x 15'-11"

OFFICE
 15'-7" x 10'-3"

EXERCISE ROOM
 10'-11" x 28'-11"

BEDROOM 2
 13'-6" x 14'-5"

BEDROOM 3
 14'-6" x 14'-8"

BEDROOM 4
 13' x 14'-5"

BEDROOM 5
 12' x 13'-10"

BALCONY
 8'-6" x 17'-2"

BEDROOM 6
 17'-9" x 15'-8"



The dimensions stated for this unit floor plan are approximate because there are various recognized methods for calculating the square footage of a unit. The square footage stated here is calculated from the exterior boundaries of the exterior walls to the centerline of interior demising walls without deductions for cutouts, curves, or architectural features. This method typically results in quoted dimensions greater than the dimensions that would be determined by using other accepted methods. The definition of "Unit" and the calculation method to be relied upon is set forth by the Developer in Developer's prospectus and the method set forth in the Developer's prospectus may result in a square footage calculation less than the method used here. Consult the Developer's prospectus to learn Unit dimensions and what is offered with the Unit. Dimensions and unit configuration is not guaranteed and may change during construction. Depictions of furnishings, fixtures and other items of personal property are not included with purchase.

N 25° 45.8255



*

W 80° 8.4428