

RESIDENCE 05C

INTERIOR	EXTERIOR
8,930 F ²	1,590 F ²
829.62 M ²	147.72 M ²

TOTAL
10,520 F²
977.34 M²

*

- 6 BEDROOMS
- 8 BATHROOMS
- 2 POWDER ROOMS
- FAMILY ROOM
- LIBRARY
- OFFICE
- SERVICE SUITE
- WINE ROOM
- EXERCISE ROOM

OCEAN VIEW

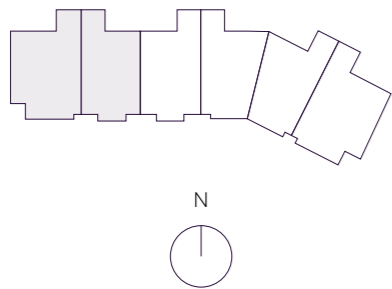

THE RESIDENCES

SIX FISHER ISLAND

⑥

The dimensions stated for this unit floor plan are approximate because there are various recognized methods for calculating the square footage of a unit. The square footage stated here is calculated from the exterior boundaries of the exterior walls to the centerline of interior demising walls without deductions for cutouts, curves, or architectural features. This method typically results in quoted dimensions greater than the dimensions that would be determined by using other accepted methods. The definition of "Unit" and the calculation method to be relied upon is set forth by the Developer in Developer's prospectus and the method set forth in the Developer's prospectus may result in a square footage calculation less than the method used here. Consult the Developer's prospectus to learn Unit dimensions and what is offered with the Unit. Dimensions and unit configuration is not guaranteed and may change during construction. Depictions of furnishings, fixtures and other items of personal property are not included with purchase.

- BALCONY
100'-9" x 14'-8"
- FAMILY ROOM
22' x 18'
- BALCONY
15' x 33'-7"
- PRIMARY BEDROOM
17'-7" x 20'
- GREAT ROOM
52'-5" x 29'-7"
- HER BATHROOM
13'-3" x 11'
- KITCHEN
20' x 27'-4"
- EXERCISE ROOM
13'-11" x 27'-5"
- HIS BATHROOM
13'-3" x 11'
- HER WARDROBE
12'-8" x 11'-5"
- HIS WARDROBE
12'-6" x 11'-5"
- OFFICE
11'-5" x 12'-5"
- WINE ROOM
11'-4" x 11'-3"
- BEDROOM 2
24'-6" x 17'-4"
- BEDROOM 3
14'-8" x 13'-4"
- BEDROOM 4
14' x 12'
- BEDROOM 5
24'-6" x 17'-4"
- BEDROOM 6
14'-8" x 13'-4"



N 25° 45.8255



W 80° 8.4428