

RIVAGE

BAL HARBOUR

BAY PENTHOUSE FLOORS

C 22, 23, 24

- 5 BEDROOMS
- 9 BATHROOMS
- POWDER ROOM
- 2 DEN / SERVICE
- FAMILY ROOM
- FITNESS STUDIO
- SKY ROOM
- OUTDOOR KITCHEN
- POOL
- PRIVATE ELEVATOR

INTERIOR
8,677 SF | 806 SQM

EXTERIOR
4,928 SF | 458 SQM

TOTAL
13,605 SF | 1,264 SQM

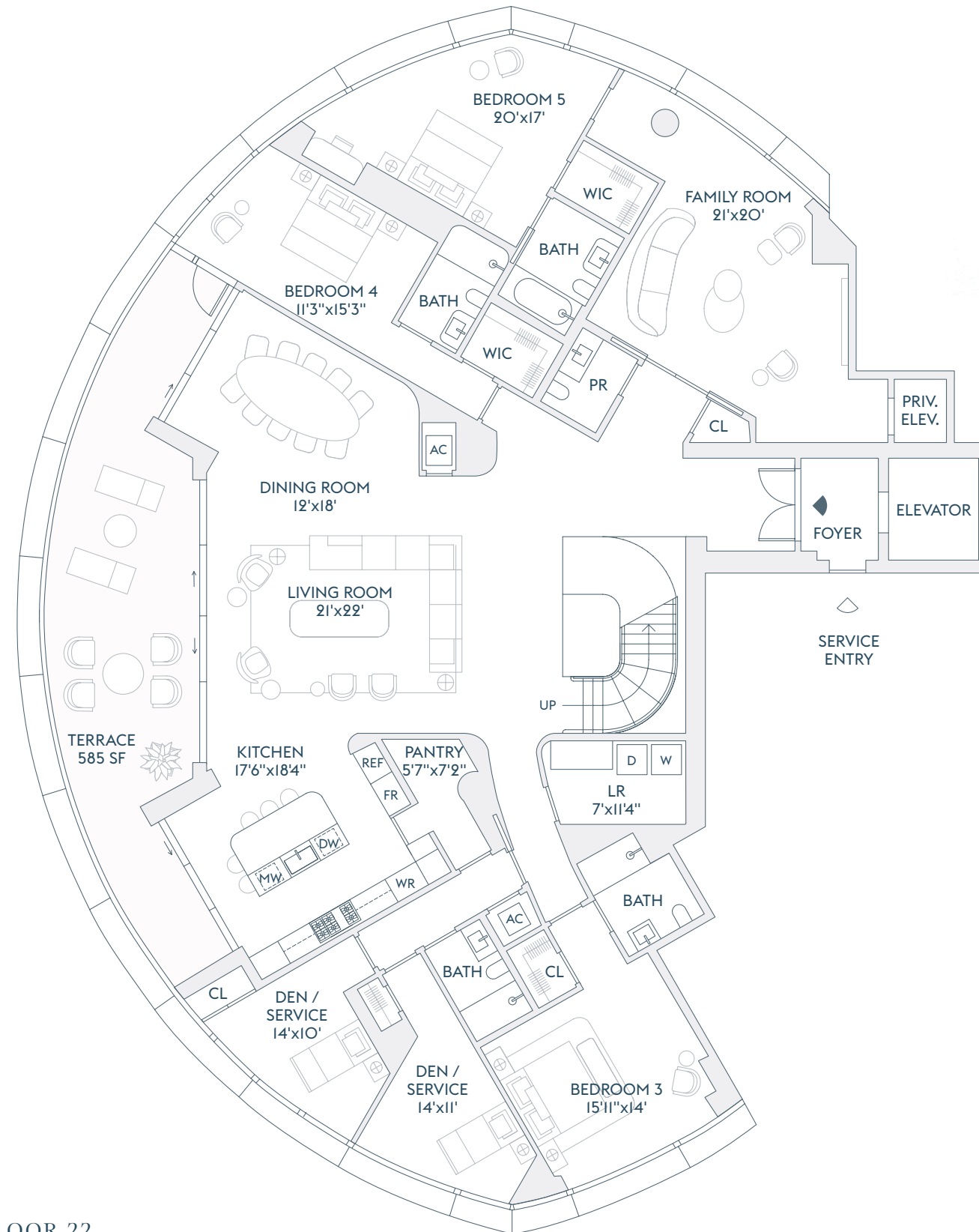

FLOOR 22

The dimensions stated for this floor plan are approximate because there are various recognized methods for calculating the square footage of a unit. The square footage stated here is calculated from the exterior boundaries of the exterior walls to the centerline of interior demising walls without deductions for cutouts, curves, or architectural features. This method typically results in quoted dimensions greater than the dimensions that would be determined by using other accepted methods. The definition of "Unit" and the calculation method to be relied upon is set forth by the Developer in Developer's prospectus which method may result in a square footage calculation less than the result of the calculation method used here. Renderings depict features not included with purchase, but which are available at an additional cost such as wine bar and closet millwork among others. Consult the Developer's prospectus to learn what is included with Unit purchase and to understand Unit dimensions. 2023 © Carlton Terrace Owner LLC, with all rights reserved.

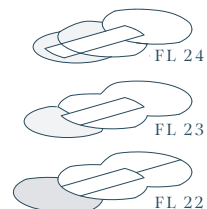
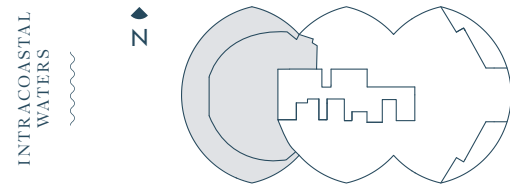

RIVAGE

BAL HARBOUR

BAY PENTHOUSE FLOORS

C 22, 23, 24

- 5 BEDROOMS
- 9 BATHROOMS
- POWDER ROOM
- 2 DEN / SERVICE
- FAMILY ROOM
- FITNESS STUDIO
- SKY ROOM
- OUTDOOR KITCHEN
- POOL
- PRIVATE ELEVATOR

INTERIOR
8,677 SF | 806 SQM

EXTERIOR
4,928 SF | 458 SQM

TOTAL
13,605 SF | 1,264 SQM



FLOOR 23

The dimensions stated for this floor plan are approximate because there are various recognized methods for calculating the square footage of a unit. The square footage stated here is calculated from the exterior boundaries of the exterior walls to the centerline of interior demising walls without deductions for cutouts, curves, or architectural features. This method typically results in quoted dimensions greater than the dimensions that would be determined by using other accepted methods. The definition of "Unit" and the calculation method to be relied upon is set forth by the Developer in Developer's prospectus which method may result in a square footage calculation less than the result of the calculation method used here. Renderings depict features not included with purchase, but which are available at an additional cost such as wine bar and closet millwork among others. Consult the Developer's prospectus to learn what is included with Unit purchase and to understand Unit dimensions. 2023 © Carlton Terrace Owner LLC, with all rights reserved.

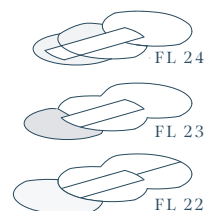
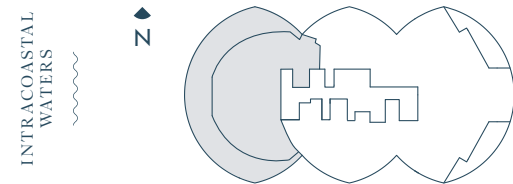

RIVAGE

BAL HARBOUR

BAY PENTHOUSE FLOORS

C 22, 23, 24

- 5 BEDROOMS
- 9 BATHROOMS
- POWDER ROOM
- 2 DEN / SERVICE
- FAMILY ROOM
- FITNESS STUDIO
- SKY ROOM
- OUTDOOR KITCHEN
- POOL
- PRIVATE ELEVATOR

INTERIOR
8,677 SF | 806 SQM

EXTERIOR
4,928 SF | 458 SQM

TOTAL
13,605 SF | 1,264 SQM

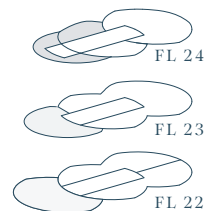
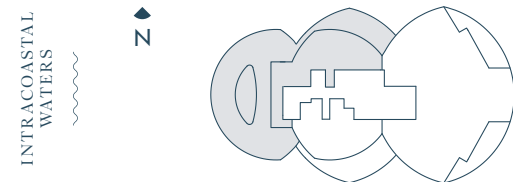
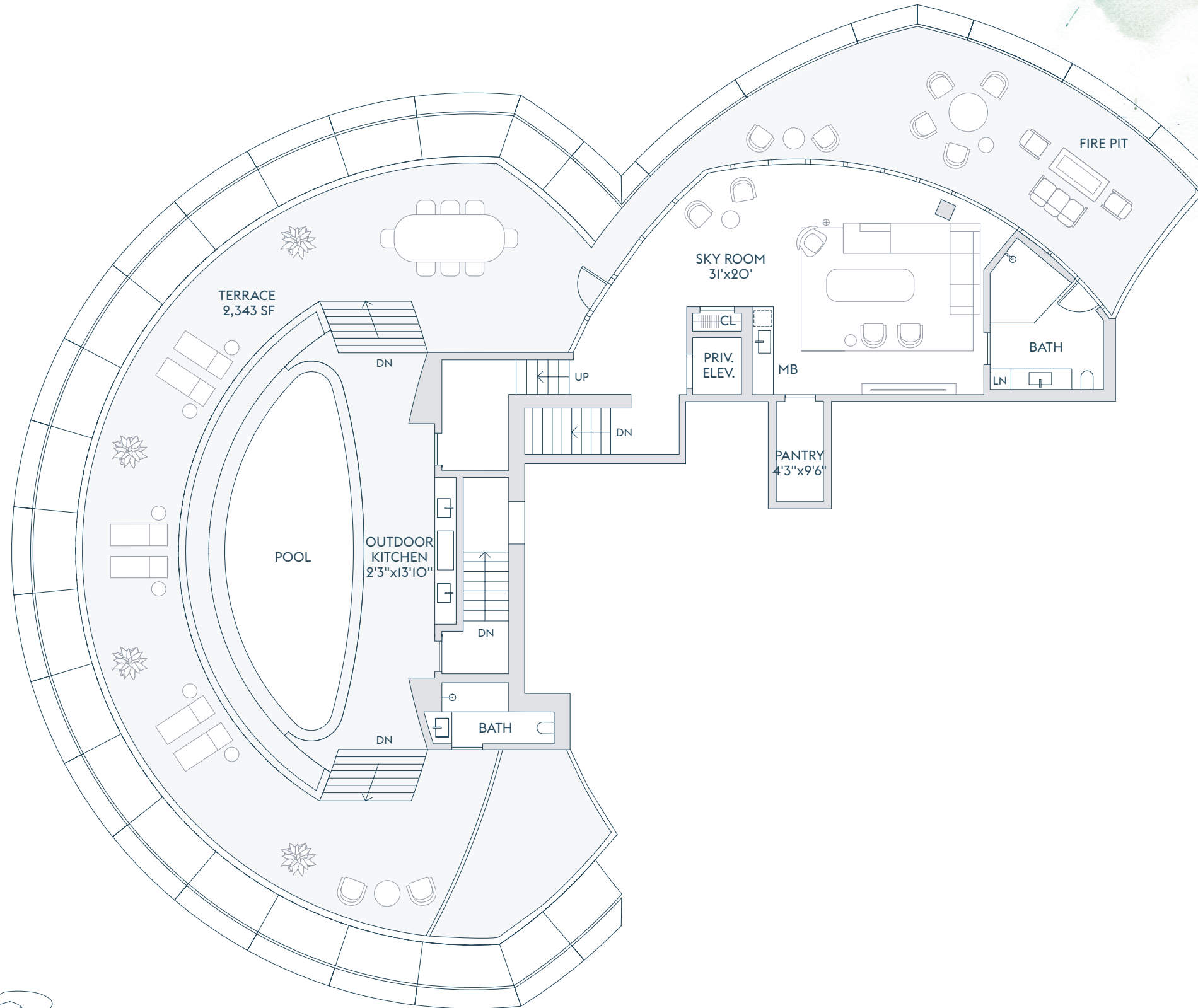

FLOOR 24

The dimensions stated for this floor plan are approximate because there are various recognized methods for calculating the square footage of a unit. The square footage stated here is calculated from the exterior boundaries of the exterior walls to the centerline of interior demising walls without deductions for cutouts, curves, or architectural features. This method typically results in quoted dimensions greater than the dimensions that would be determined by using other accepted methods. The definition of "Unit" and the calculation method to be relied upon is set forth by the Developer in Developer's prospectus which method may result in a square footage calculation less than the result of the calculation method used here. Renderings depict features not included with purchase, but which are available at an additional cost such as wine bar and closet millwork among others. Consult the Developer's prospectus to learn what is included with Unit purchase and to understand Unit dimensions. 2023 © Carlton Terrace Owner LLC, with all rights reserved.