

1 BEDROOMS
1 BATHROOMS

INTERIOR	466 SF	43 M ²
EXTERIOR	102 SF	9 M ²
TOTAL	568 SF	53 M ²

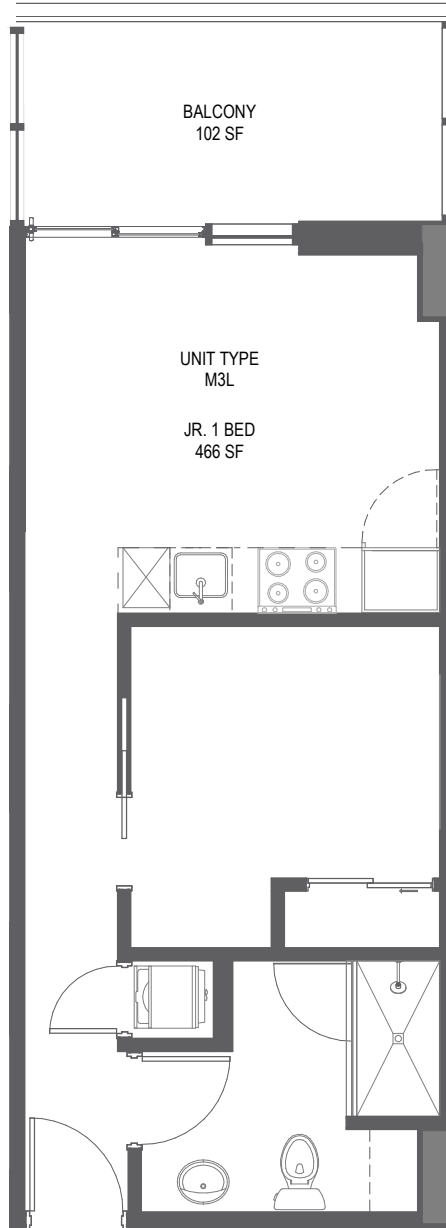
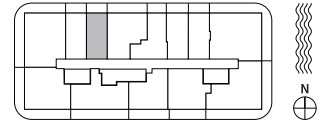

ORAL REPRESENTATIONS CANNOT BE RELIED UPON AS CORRECTLY STATING THE
STATUTES, TO BE FURNISHED BY A DEVELOPER TO A BUYER OR LESSEE.

This is not intended to be an offer to sell, or solicitation to buy, condominium
condominium and no statement should be relied upon if not made in the prospectus
common elements or shared facilities without excluding areas that may be occu-
pation of the Unit set forth in the Declaration (which generally only includes the
Declaration is set forth in Exhibit "3" to the Declaration. All dimensions are approximate.

OF THE DEVELOPER. FOR CORRECT REPRESENTATIONS, MAKE REFERENCE TO THIS BR

any jurisdiction where prohibited by law, and your eligibility for purchase will depend upon
square footage is measured to the exterior face of exterior walls and to the centerline of int
other structural components. This method of measurement varies from, and is larger than
between the perimeter walls and excludes structural components). For reference, the area
with actual construction.

THE DOCUMENTS REQUIRED BY SECTION 718.503, FLORIDA

Exclusive sales & marketing by
CERVERA
REAL ESTATE • 1989



residency. The offering is made only by the prospectus for the
walls or to the exterior face of walls adjoining corridors or other
is that would be determined by using the description and the
defined in accordance with the unit boundaries set forth in the